



Installation Instructions

FRONT RADIUS ROD KIT- Part # SS404RR

Estimated installation time is 2.0 hours.

This product is designed to eliminate fore & aft shift of the front axle for Ford F-53 2020 & UP V-8 16k to 26k GVW Chassis

Caution: Proper service and repair procedures are essential for safe and reliable installation of chassis parts. They require experience and tools that may be specially designed for the purpose. These parts should be installed by a qualified mechanic; otherwise an unsafe vehicle and/or personal injury may occur.

NOTE: Radius rods should be installed and adjusted with weight on the front suspension.
Will not fit with front Sumo Springs installed.

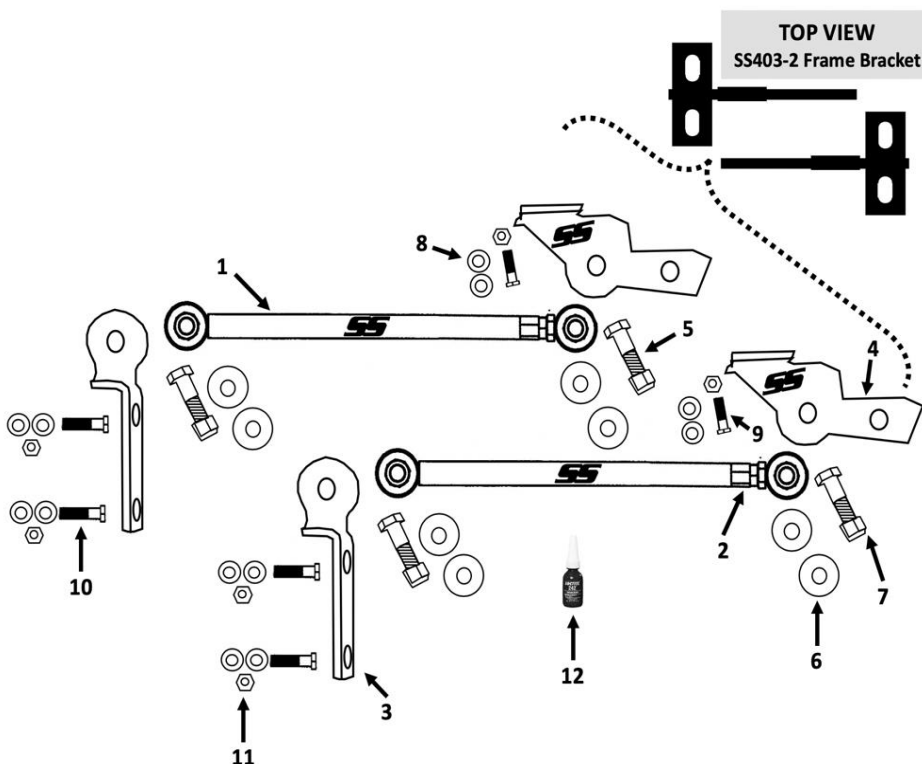

Item #	Description	Qty.
1	SS 403-1 Rod Assy.	1
2	Jam Nut – 3/4 16 UNF (on rod assembly)	1
3	SS403-3 Axle bracket	2
4	SS403-2 Frame Bracket	2
5	3/4 x 3 16 UNF Bolts	4
6	Flat washers – 3/4	8
7	Top lock nut-3/4 16 UNF	4
8	Flat Washer 1/2	12
9	Bolts 1/2 x 1.5 nc	2
10	Bolts 1/2 x 2 nc	4
11	Nuts 1/2 nc lock	6
12	Loctite small tube	1

Item#	Torque Specs = Ft/Lbs
2	100 - 120
5 & 7	120 - 150
9,10,11	75 - 80
SPRING EYE BOLT	120 - 140

SS404 Radius Rod Kit Ford F53 V-8 front



Remove the nut (**PHOTO 1**) from the forward spring eye bolt (15/16 wrench for nut)(13/16 or 21mm for bolt head)

Save the nut it will be reused. Install the frame bracket (SS403-2) over the spring eye bolt with the flat plate towards the rear and facing upwards so it sits flat against the bottom of the frame rail.

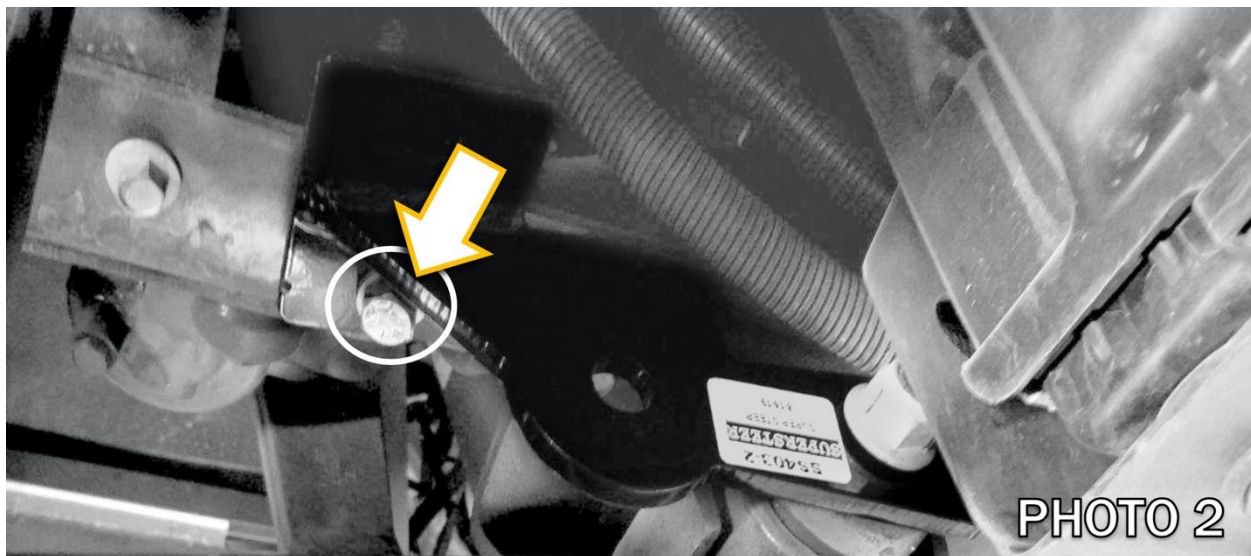

Align the hole in the bracket with the hole in the frame and install the new $\frac{1}{2}$ " x 1.5" bolt with flat washer from the bottom up (**PHOTO 2**) through the bracket and frame with flat washer and nut on top side. # Note $\frac{1}{2}$ " holes may have to be drilled. #

Install the spring eye nut with a dab of lock-tite and tighten to 120 to 140 ft lbs. Tighten the $\frac{1}{2}$ " bolt to 75-80 ft lbs. Repeat these steps for the other side. Loosen the four sway bar u-clamp axle bolts.



Remove two bolts from drivers (**PHOTO 3**) and install the B1058 axle bracket with the round end upwards and angle towards the rear.

Install with new $\frac{1}{2}$ " x 2" bolts, flats, lock nuts Repeat on the passenger side using B1059 axle bracket and then tighten all four bolts (75 to 80 ft lbs).

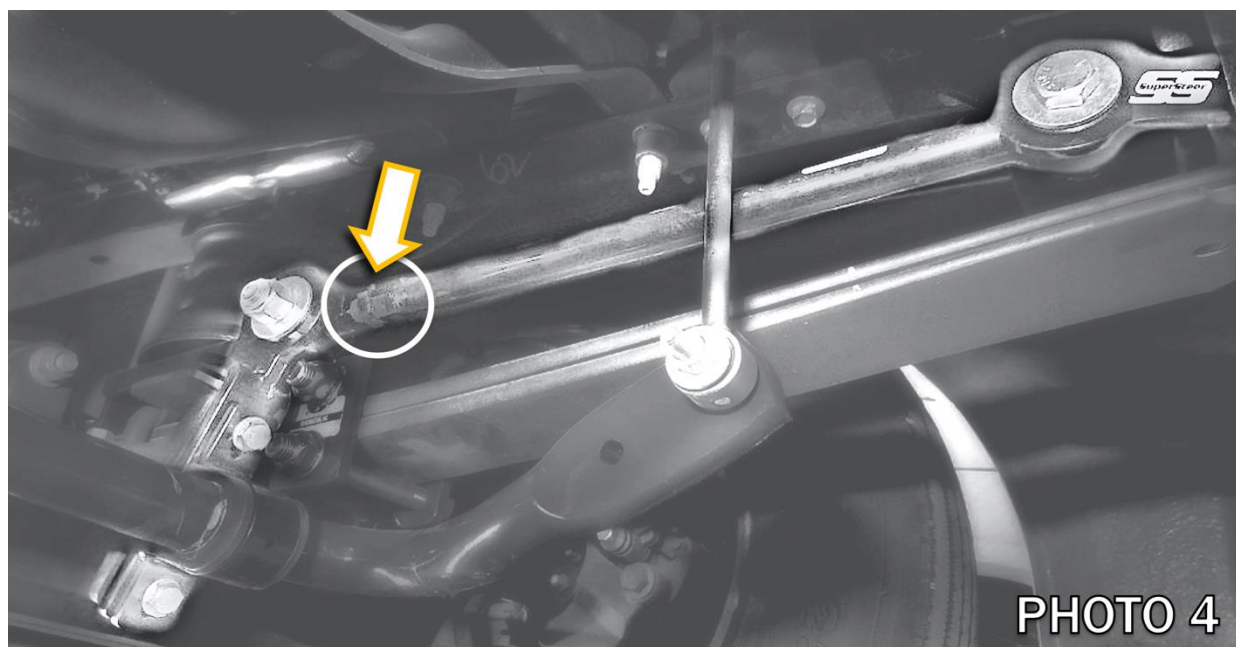

Adjust the radius rods to length and install on frame bracket with $\frac{3}{4}$ " x 3" bolts, flat washers and lock nuts capturing the bushings on both sides with the flat washers. Install radius rod to outside of axle brackets with SS519-5 spacers in between rod end and axle bracket using $\frac{3}{4}$ " x 4.5" bolts, flat washers, nuts.

The radius rods can be installed on either side of the frame brackets for best clearance and alignment. Tighten all $\frac{3}{4}$ " bolts 120 to 150 ft lbs. and tighten the jam nuts (**PHOTO 4**) on the radius rod to approximately 100 to 120 ft lbs. with a dab of lock-tite. **Congratulations your install is complete!**

NEXT STEPS:

- Please do a test drive to ensure proper installation.
- Warranty card. (Mail in or Complete Online)
- Re-check torque in 6 months.

Thank you for your purchase of the SuperSteer® Front Radius Rod

Your comments are greatly appreciated. Please feel free to contact **SuperSteer®** at 888-898-3281 or e-mail at sales@supersteerparts.com